

IW16 UNDERWATER IMPACT WRENCH

STANLEY®



SPECIFICATIONS

Capacity	1" Square Drive
Torque	500 -2500 ft lbs / 680-3400 Nm
Flow Range	7-12 gpm / 26-45 lpm
Working Pressure	1500-2000 psi / 105-140 bar
Full Relief Setting	2250 psi / 155 bar
Weight	26 lbs / 12 kg
Length	15" / 38 cm
Width	4.5" / 11 cm
Hydraulic Ports	-8 SAE O-ring
Connect Size and Type	3/8" Male Pipe Adapter
Couplers	(See Ordering Information)
Hose Whips	No (See Accessories)



The Stanley **IW16** is a heavy duty 1" square drive impact wrench designed for the toughest underwater bolting applications. Powered by a Stanley integral Hyrevz motor, the **IW16** has a durable swing hammer impact mechanism with adjustable impact intensity from 500 to 2500 ft lbs (680 to 3400 Nm) of torque. Designed to run from a wide range of hydraulic circuits. "D" style grip handle with multi-position assist handle and hi-visibility yellow paint is standard.

FEATURES

- Integral Stanley Hyrevz gear motor produces high torque
- Stainless Steel spools and fasteners
- Forward-Reverse with variable speed
- "D" style grip handle with inside trigger
- Feathering on/off trigger for precise control
- Adjustable impact intensity
- 2500 ft lbs/3400 Nm of maximum impact torque
- Durable swing hammer mechanism
- Cast-in lifting eye

IW16 UNDERWATER IMPACT WRENCH

STANLEY[®]

ORDERING INFORMATION

PART NUMBER

IW16350 Impact Wrench, Underwater, 1" Square Drive, with couplers, CE

ACCESSORIES

03971	Flush-Face Coupling Set, 3/8" NPT
03974	Flush-Face Coupling Set, 1/2" NPT
06830	Hose Whip 18" long, -8 SAE x 1/2" NPT
31848	Dual Hose, 50' x 1/2", with couplers
31972	Dual Hose, 25' x 1/2", with couplers
58633	Twinned Hose, 25' x 1/2", with couplers
58634	Twinned Hose, 50' x 1/2", with couplers
31203	Extension, 10", 1" Drive
33276	Socket Retainer Pin, 1" Square Drive Socket
33277	Socket Retainer Ring, 1" Square Drive Socket

When hydraulic hose exceeds 100' (30.4 m) in length, increase I.D. of both pressure and return hose. For more information, consult Stanley Hydraulic Tools.

IMPORTANT

To fill out a Product Warranty Recording form and for information on your warranty visit stanleyhydraulic.com and select the Warranty tab.

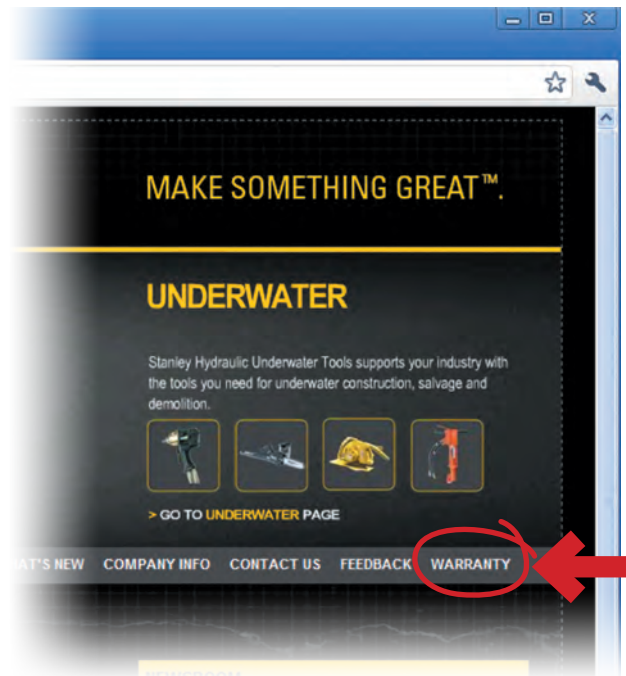

Note: The warranty recording form must be submitted to validate the warranty.

All Stanley Hydraulic Tools, parts, accessories and allied equipment are subject to design improvements, specifications and price changes at any time without notice and with no obligation to units already sold. Weights, dimensions and operating specifications listed herein are subject to change without notice. Where specifications are critical to your applications, please consult Stanley Hydraulic Tools.

STANLEY

Stanley Hydraulic Tools | 3810 SE Naef Road | Milwaukie, Oregon 97267 | +01.503.659.5660 | 800.972.2647 | www.stanleyhydraulic.com