

BR67 UNDERWATER BREAKER/DRIVER

STANLEY



SPECIFICATIONS

Performance	1300 bpm @ 8 gpm
Steel Capacity	1½" x 6" Hex
Handle Type	T-Handle
Circuit Type	Open Center
Flow Range	7-9 gpm / 26-34 lpm
Optimum Flow	8 gpm / 30 lpm
Working Pressure	1500-2000 psi / 105-140 bar
Full Relief Setting	2250 psi / 155 bar
Weight (less tool bit)	73 lbs / 33 kg
Length	29" / 73.6 cm
Width (at handles)	16" / 41 cm
Hydraulic Ports	-8 SAE O-ring
Couplers	No (See Accessories)
Hose Whips	Yes (¾" NPT Male thread)

FEATURES

- T-Handle with large on/off trigger for precise control
- Stainless Steel spool and fasteners
- Trouble free diaphragm accumulator provides additional blow energy and reduces recoil
- Feathering on/off valve allows easy initial tool bit placement
- Uses standard 1½" x 6" hex shank tool bits
- Four tie rod design for durability
- Operates in any position
- Modular design for ease of service
- Latch retainer



The **BR67** is a medium sized breaker in Stanley Hydraulic Tools line up of underwater paving breakers. The **BR67** is in the 70 lbs class of breakers and is used for medium concrete and rock breaking, coral removal and rod driving. The feathering on/off valve controls speed and allows easier initial tool placement. Standard 1½" x 6" hex chuck and latch retainer. Painted hi-visibility yellow.

BR67 UNDERWATER BREAKER/DRIVER

STANLEY

ORDERING INFORMATION

PART NUMBER

BR67320 Paving Breaker, Underwater, 1 1/8" Hex, less couplers

ACCESSORIES

03971	Flush-Face Coupling Set, 3/8" NPT
03974	Flush-Face Coupling Set, 1/2" NPT
31848	Dual Hose, 50' x 1/2", with couplers
31972	Dual Hose, 25' x 1/2", with couplers
58633	Twinned Hose, 25' x 1/2", with couplers
58634	Twinned Hose, 50' x 1/2", with couplers
02331	Clay Spade, 1 1/8" Hex, 5 1/2" Wide Blade
02332	Asphalt Cutter, 1 1/8" Hex, 5" Wide Blade
02333	Moil Point, 1 1/8" Hex, 14" under collar
02334	3" Wide Chisel, 1 1/8" Hex, 14" under collar
03990	Narrow Chisel, 1 1/8" Hex, 14" under collar
04176	Rod Driver, 1 1/8" Hex, 1" rod
08106	Asphalt Wedge, 1 1/8" Hex

When hydraulic hose exceeds 100' (30.4 m) in length, increase I.D. of both pressure and return hose. For more information, consult Stanley Hydraulic Tools.

IMPORTANT

To fill out a Product Warranty Recording form and for information on your warranty visit stanleyhydraulic.com and select the Warranty tab.

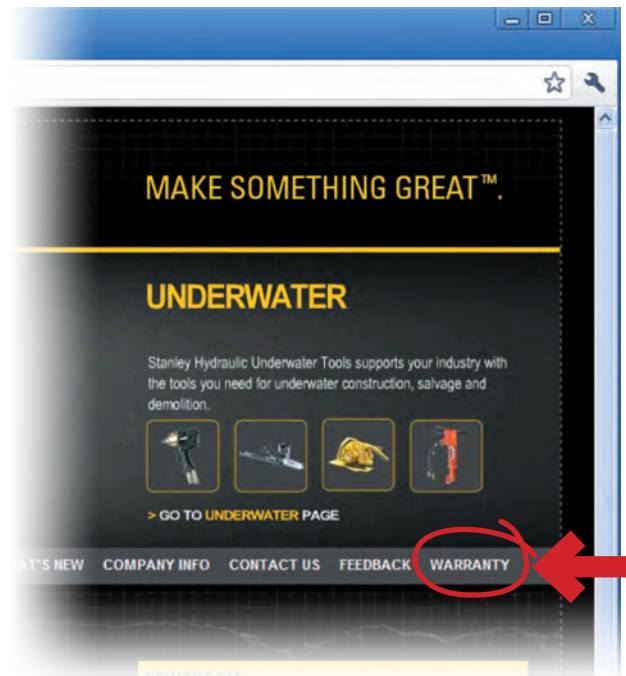

Note: The warranty recording form must be submitted to validate the warranty.

All Stanley Hydraulic Tools, parts, accessories and allied equipment are subject to design improvements, specifications and price changes at any time without notice and with no obligation to units already sold. Weights, dimensions and operating specifications listed herein are subject to change without notice. Where specifications are critical to your applications, please consult Stanley Hydraulic Tools.